

Jazzy
Swift

PRIDE[®]
MOBILITY PRODUCTS LTD.
LIVE YOUR BEST[®]

32 Wedgwood Road,
Bicester, Oxon, OX26 4UL

www.pride-mobility.co.uk



OWNER'S MANUAL

PRIDE[®]
MOBILITY PRODUCTS LTD.
LIVE YOUR BEST[®]
www.pride-mobility.co.uk
www.quantumrehab.co.uk

CE UK
CA

32 Wedgwood Road Bicester, Oxon OX26 4UL
United Kingdom

1.Instruction.....	2
2.precautions for safe use.....	3-10
3.Structure and Performance.....	11-12
4.Specification.....	13
5.Installation, Folding and Debugging.....	14-15
6.Use and Operation.....	16-20
7.Fault Diagnosis and Troubleshooting.....	20
8.Safety Devices and Accident Treatment.....	21
9.Maintenance.....	21-23
10.Transportation and Storage.....	24
11.Opening and Checking	24
12.Warranty.....	25

Manufactured by INNUOVO, distributed by Pride Mobility
WARNING: Please read the user manual before operating this wheelchair.

Manufacture by:
 Zhejiang Innuovo Rehabilitation Devices
 Co.,Ltd
 No.196 Industry Road, Hengdian Movie
 Zone, Dongyang, Zhejiang, China.
 TEL: 86-0579-89302863
 FAX: 86-0579-89327233

Distributed by:
 Pride Mobility Products Ltd
 32 Wedgwood Road Bicester,
 Oxon OX26 4UL United Kingdom

Rev:A/1

1.Instruction

Read and follow all instructions, warnings, and notes in this manual before attempting to operate your power wheelchair for the first time. If there is any information in this manual which you do not understand, or if you require additional assistance for assembly or operation, please contact with your authorized local provider. These symbols below in this manual are used to identify warnings and important information. All of them are very important to your safety. It is strongly recommended that you should read and understand them completely.



WARNING! Failure to heed the warnings in the manual may result in personal injury.



ATTENTION! Failure to heed the cautions in the manual may result in damage to the power wheelchair.

1.1Indications for use

The Power Wheelchair, N5901, is a motor driven, indoor and outdoor transportation vehicle with the intended use to provide mobility to a disabled or elderly person limited to a seated position.

1.2 This power wheelchair is applicable to the disabled. The maximum loading weight is 100kg.

1.3 The power wheelchair is outdoor type, which is applicable to outdoor and flat roads near buildings, but it shall not be used on grass, gravel roads, steep slopes or highways, nor in rain and snow.

1.4We reserve the right to change and update this manual without notice. The power wheelchair conforms to ISO7176 standard.

This manual will help you understand the functions of the wheelchair. In addition, operation, maintenance and repair are described. If you have any other questions, please contact your dealer or retailer.

2. Precautions for Safe Use



Warning! To ensure your safety, please read and understand this manual. You must be on high alert when driving any vehicle to ensure safety.



Warning! Please read the following warning carefully to avoid damage or personal injury caused by improper operation. Wheelchair users should take appropriate safety measures and obey local pedestrian traffic rules. The company are not responsible for personal injury and/or product damage caused by improper operation. When you sit in the wheelchair, it may be difficult for others to see you. Use of safety equipment such as reflectors, reflective clothing, lights and safety signs is critical to your safety.



Warning! Please consult your health care professional regularly to ensure that there are no health or physical conditions that limit or compromise your safe operation of the wheelchair. If you are taking prescription or over-the-counter medications, or if physical activity is limited, please consult your physician. Some medications and medical conditions may impair your ability to operate the wheelchair.



Warning! Do not operate your wheelchair while drunk. Drinking may affect your safe operation of the wheelchair.
Warning! All wheelchairs are not the same. Please take time to learn before driving.
Warning! Be able to operate a wheelchair safely needs time and practice.



Warning! Please do not use the wheelchair for other purposes, applications such as weight training, sports and athletics, traction, moving or dragging may cause safety hazards and excessive stress in wheelchairs.
Warning! This wheelchair is for one person only, the maximum load weight as 135kg with no passengers allowed. Do not carry anything to avoid overloading and possible rollover.



Warning! We strongly recommend that you do not smoke in the wheelchair. If you decide to smoke in the wheelchair, please abide by the following safety rules: keep ash at a safe distance from the wheelchair seat. Make sure your cigarette is extinguished completely when you throw it away.



Warning! Before getting on/off the wheelchair, you should sit back as far as possible to avoid injury caused by overturning.
Warning! The arm rests are not transfer bars, do not use them transfer out of the chair as this may cause damage to the product or injury to yourself.
Warning! Avoid concentrating your weight on the footrest. Otherwise, it will cause overturning and personal injury.



Warning! Do not use the wheelchair in manual mode without accompanying person, which could cause personal injury.
Warning! When sitting in the wheelchair, please do not move by yourself, which will cause personal injury. Ask your accompanying person for help if necessary.
Warning! Do not make any alterations to the wheelchair without permission. Adding accessories may change some of the wheelchair specifications such as total weight, size, or center of gravity. Please note that some changes may damage things around you.
Warning! Please do not change your seat specification. Do not place any cushions or pillows on the seat, which could result in the user falling out from the wheelchair caused by instability of seat.



Warning! Be extremely careful when using oxygen near electrical circuits or combustible materials. Please contact your oxygen supplier for information on the safe use of oxygen.



Attention! Do not change the controller Settings. Please ask your service provider to check the controller Settings every 6-12 months. If you notice any changes in your ability to control the wheelchair, please contact your service provider.



Warning! During the operation, the wheelchair may suddenly stop at any time. Do not operate the wheelchair if it is abnormal or irregular.



Warning! To prevent the wheelchair from losing control and moving on its own, do not place the wheelchair in manual mode on any inclined plane.



Warning! If you expect to sit in a fixed position for a long time, turn off the power to prevent accidental movement of the wheelchair.



Warning! Avoid any accessories that may interfere with the operation of the joystick. Otherwise, it will cause the wheelchair to move unexpectedly.



Warning! Keep yourself, clothing and other objects away from the wheel while the wheelchair is moving. Do not drag anything behind the wheelchair while driving. Loose clothing and other items can get sucked into tires and/or turning gears.



Attention! Do not connect any other devices to the electronic system or turn on any other devices with the wheelchair battery.
Attention! When disconnecting wiring harness, please hold the terminal in case damage to it. Do not pull the wiring harness directly.



Warning! Keep all charger connector terminals clean and dry, away from damp sources to prevent damage to electrical system and/or personal injury.



Attention! The storage temperature of wheelchair is -15°C~40°C. Long-term storage in low or high temperature environment will damage its function.



Attention! Always check electrical components for corrosion. Check all brakes for looseness, wear or damage. Check wiring harnesses and terminal posts for breakage. If necessary, please contact your service provider.



Attention! Please ensure the safety of wheelchairs and batteries during transportation. Never transport wheelchairs or batteries with combustible materials.



Attention! Please use the battery under the supervision of service technicians authorized by the company. Battery connectors, terminals and related accessories contains lead and lead components to contains lithium, lead and lead components



Attention! Do not connect the cable directly to the battery terminal/clip for charging.
Attention! Do not remove the fuse from the battery harness. If the fuse is damaged, please contact your supplier for replacement.



Warning! Do not operate the wheelchair with dead battery. You might get trapped.
WARNING! Please slow down when turning, do not make sharp turns. Keep the center of gravity stable when turning. To prevent rollover, do not move the center of gravity in the opposite direction when turning.



WARNING! Drive straight up the slope when climbing; both front wheels should land at the same time. To reduce the possibility of overturning, do not make an angle with the slope; do not make the wheel on one side or the side of the wheelchair to go up the slope first. Be particularly careful when climbing any slopes.



WARNING! Do not drive on potentially dangerous roads or slopes, including but not limited to roads covered with snow, ice, cut grass, or wet leaves.



WARNING! Keep the wheelchair moving when climbing. If you need to stop, restart slowly and speed up carefully.



WARNING! Please drive down a slope at the minimum speed. If the descent speed is faster than expected, release the joystick lever to stop the wheelchair, and then press the lever lightly to control the descent speed.



WARNING! The recommended maximum climbing angle (see parameter table) was tested in a controlled environment. Your wheelchair's ability to climb is affected by factors such as your weight, the speed of your wheelchair, and the angle at which you approach the slope.



WARNING! Reversing is only possible on flat roads. When reversing, please operate smoothly at low speed. Please stop frequently and check to make sure there are no obstacles on the road. To prevent rollover, do not tilt down or backward along the slope.



WARNING! When sitting in a wheelchair, avoid any position or movement that can change your center of gravity. This may cause the wheelchair to tilt.



WARNING! Do not put all the weight on one side of the wheelchair deck, such use may cause the wheelchair to tilt.

WARNING! Do not put your hands above the seat or tilt your body. This may damage the backrest and cause you to fall down.



WARNING! Even if your wheelchair can cross high obstacles, we recommend that you do not try to cross a height exceeding 25mm. Such operations may cause the wheelchair to be unstable. Riding a wheelchair over an obstacle of such height can cause a rollover and severe personal injury. If you have any concerns about safely crossing obstacles, please ask for help. Please pay ATTENTION to your operating skills and personal restrictions. You may need to remove or cover the sills and install ramps at exits and entrances.



WARNING! Do not attempt to climb over obstacles on slopes.
WARNING! Do not rely on a wheel to get over obstacles.



WARNING! Never operate the wheelchair near railroad tracks or crossings.



WARNING! Do not drive the wheelchair along the edge of a stream, lake or sea. Please do not drive the wheelchair across the water.



WARNING! Do not expose wheelchair to open flames.



ATTENTION! Keep your wheelchair in a dry and clean environment. Don't take the wheelchair to shower, bath, pool or sauna. Rain, snow, salt, fog / spray conditions and frozen / smooth surfaces can cause wheelchair screws and some fixtures to rust untimely.



ATTENTION! Avoid prolonged exposure to excessively hot and cold environments; it may damage the cushioned and non-cushioned parts of the wheelchair as well as the battery and battery components.



ATTENTION! Do not drag the wheelchair. Dragging may exceed its own speed threshold, causing damage to key parts of the wheelchair.



ATTENTION! Be extremely careful when moving an idle wheelchair up and down the stairs. The wheelchair must be folded, requiring the participation of several physically capable people.



WARNING! Do not cross stairs or escalators with the wheelchair.



WARNING! Do not sit on a wheelchair while it is in any transport vehicles.



WARNING! For safer handling: Always keep the power off before moving. Failure to do so may result in touching the joystick and causing the wheelchair to move unexpectedly. Make sure the brakes are locked so to prevent the wheelchair from moving during handling. This wheelchair could be driven into the elevator, while you must turn off the power and sit firmly to ensure that the wheelchair will not move after entering the elevator.



WARNING! Do not place the wheelchair on the front seat of the vehicle during transportation, it may move and disturb the driver.



ATTENTION! Please contact your service provider if any spare parts on the seating system are loose. Replace worn or damaged padding immediately.



WARNING! Radio wave sources, such as radio stations, television stations, amateur radio transmissions, two-way radios and mobile phones can affect wheelchair control.

The following WARNINGS should reduce the possibility of severe injury due to accidental braking or movement of the power wheelchair:

1. Do not turn on portable personal communication devices, such as citizen band (CB) radios and mobile phones when the power wheelchair is powered on;
2. Pay attention to nearby transmitters, such as radio or television stations, and try to avoid approaching them.
3. In the event of unexpected movement or brake release, the power wheelchair should be turned off as soon as possible under safe conditions;
4. Please note that adding accessories or parts, or modifying power wheelchairs may make it more susceptible to interference from radio wave sources (note: there is no easy way to assess the influences of above modifications on the wheelchair's overall immunity from radio wave sources); and report to the power wheelchair manufacturer of all accidents of unexpected movement or brake release, and pay attention to nearby radio sources and other important information.

3.STRUCTURE AND PERFORMANCE

3.1Structure of the Power Wheelchair

This power wheelchair consists of the main part including the front wheel, drive wheel, frame, controller, motor with mechanism, armrest, push handle, backrest, seat base, footrest, battery case and charger, the structure shown in Figure 1.

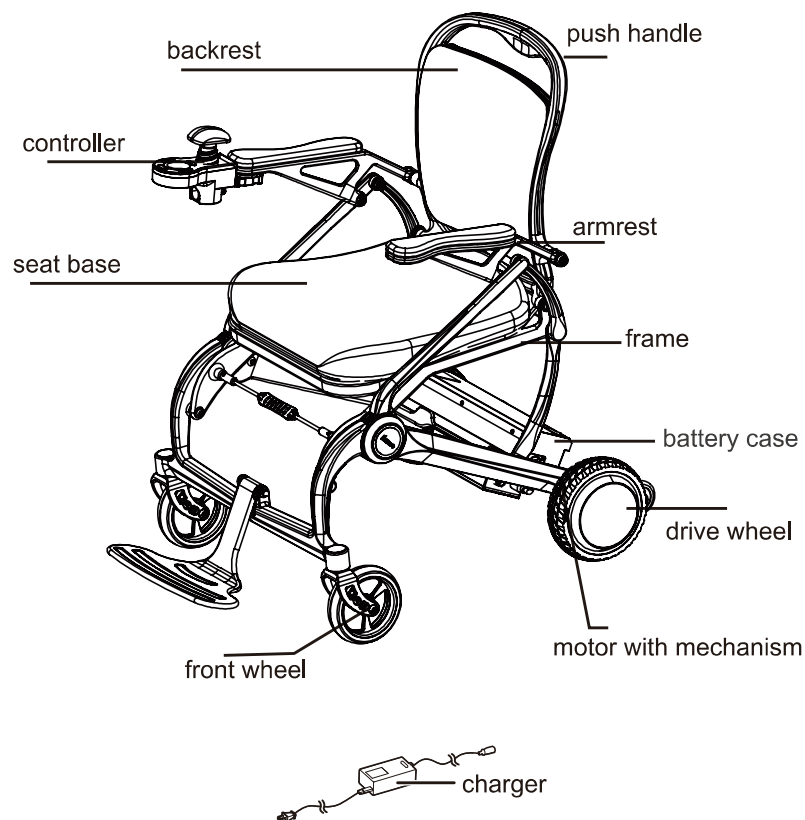
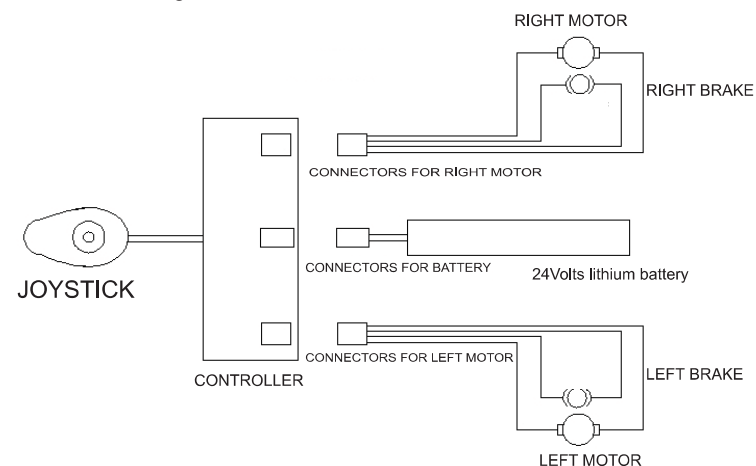

fig. 1

3.2Product characteristics of the power wheelchair

- Classification by anti-shock type: wheelchair is internal power supply;
- Classification according to the degree of anti-shock: wheelchair belongs to the B-type application part;
- Classification according to the degree of protection of the feed: IPXO;
- Safety degree when used in flammable anesthesia mixed with air or flammable narcotic with oxygen or oxidized nitrogen Category: Non-AP or APG equipment;
- By operating mode: continuous operation;
- Wheelchair rated voltage and frequency: DC 24V;
- Input power of wheelchair: internal power supply equipment;
- Whether the wheelchair has a protective effect on defibrillation effect: No;
- Whether the wheelchair has a signal output and input part: No;
- Permanent installation of equipment or non-permanent installation of equipment: mobile devices.

3.3Electric Diagram



3.4Product Software Version

Software version of Power Wheelchair N5901 is V1.0.

4.Specification

The main specification includes dimension and weight.

Overall Dimensions	800*565*770mm
Seat Height	445mm
Seat Width	430mm
Seat Depth	400mm
Arm Height	175mm
Seatback Height	380mm
Wheelchair Weight	12.5kg
Maximum Speed	6km/h
Braking Distance(on a level surface)	≤1000mm
Minimum Turning Radius	≤900mm
Weight Capacity	100kg
Theoretical Travel Ranging	15km
Static Stability	≥6°
Dynamic Stability	≥3°
Slope Performance	6°
Climing Ability	≥3°
Motor Type	24V 110W*2
Lithium Battery Type	24V/10Ah
Max. Output Current of Controller	35A
Max. Output Current of Charger	2A
Front Wheel	Inflate-free Tyre, O.D. 125mm
Rear Wheel	Inflate-free Tyre,O.D. 165mm

- ①The weight capacity is tested with a dummy or personnel of same weight.
②Theoretical Travel Ranging is tested on flat road with average speed.
It will vary due to drive surface, operation habit,etc.

5.1 Assembling

5.1.1Open the packing box, remove the electric wheelchair, and remove all protection on the frame. (fig1) Stand upright on the flat ground and flip the pedal to the contact point.

Note: This frame is a carbon fiber wheelchair, so it is recommended to place or open it upright on a sundry carpet or soft fabric mat.

5.1.2 before the wheelchair, the user stood in the wheelchair (fig1), left hand in front frame horizontal support (fig2), the right hand hold the back against the top push (fig2), the frame body micro upright, anti tilt wheel as a fulcrum (fig2), left hand and right hand grip opposite direction (fig2), until the frame bounce into the front frame set (fig2)

5.1.3Along the "L" port, push the controller fixing rod inward, make the "bolt" contact the bottom and turn the hand controller counterclockwise to achieve its installation and fixation.(fig3)

Note:

1.Judge the pull pin smoothly into the insert, to use the wheelchair

2.In the pull pin elastic insert sleeve, the edge sleeve of the steel wire pull rod fits to the frame convex platform (fig4)

3.If the user still cannot understand the opening instructions, you can ask the local dealer or the official after-sales customer service, video demonstration or picture demonstration of how to operate.

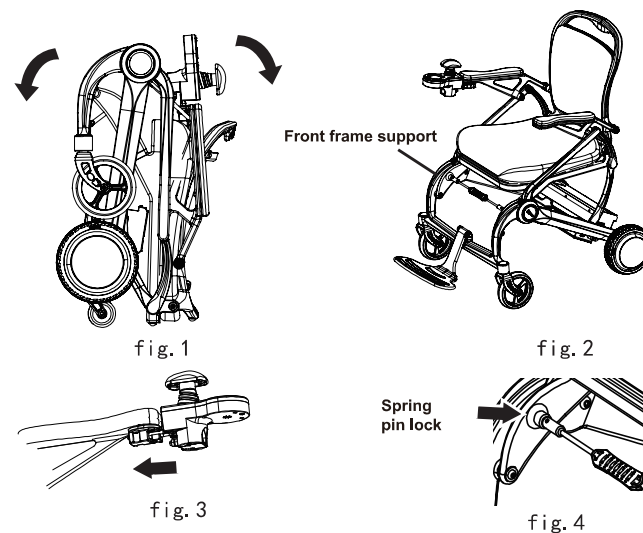

5.2 Adjusting

5.2.1 Connect the plug of the controller to the battery (fig5).

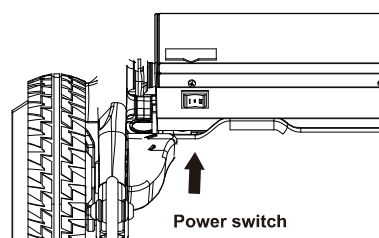

fig. 5

5.2.2 Press the "switch" button on the battery box to either end, and power on the wheelchair.

5.2.3 Press the power switch on the controller system, the controller screen is "bright", the number displayed on the screen is the current gear, and the percentage is the capacity of the battery.

5.2.4 Press the horn button to judge whether the horn is sound. Press the controller power switch, power and speed indicators on, and press "-" to set the speed to 1.

5.2.2 Anti-tip wheel frame

The anti-tip wheel is a safety device to prevent the wheelchair from overturning while driving on the slope.

5.3 Folding

During transport or storage.

5.3.1 When the wheelchair needs to be folded, then the wheelchair can be folded (fig6)

5.3.2 The wheelchair is upright, the anti-tilt wheel is the fulcrum, the right hand holds the top of the backrest, the left hand pulls the handle of the wire pull rod on the seat frame, with the top of the cushion as the force point, press according to the direction shown in the drawing, and fold the wheelchair frame to the center.

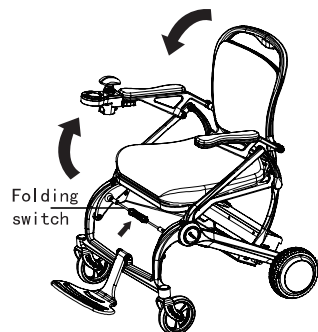

fig. 6

6. USE AND OPERATION

6.1 Use

6.1.1 All the electric components to control the wheelchair are integrated to the joystick, including ON/OFF switch; speed light; battery gauge; speed light; speed down button; speed up button; joystick. You can implement all the operations of this wheelchair the above buttons. (fig7)

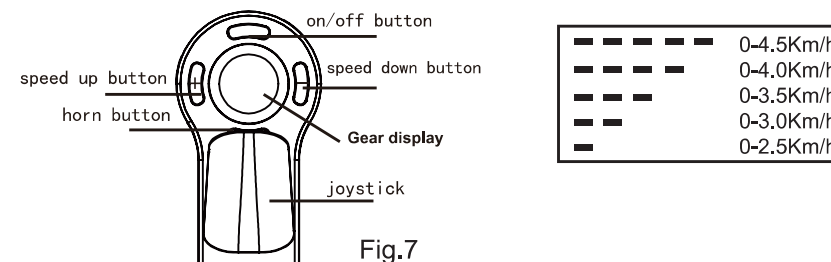

Fig.7

6.1.2 ON/OFF switch: It is the switch to supply power to the control system. Press the ON/OFF switch to turn the power on. the power indicator speed light and battery gauge will be on. Press it again, the power is off, then speed light as well as the battery gauge will go out.

6.1.3 Speed down button: After turning on the power, the speed light displays the current maximum driving speed, and will decrease by one bar with each press on it. The number of displayed bars represents the current maximum speed. The range could be adjusted by the user.

6.1.4 Speed up button: After turning on the power, speed light displays the current minimum driving speed, and will increase by one bar with each press on it. The number of displayed bars represents the current maximum speed. The range could be adjusted by the user.

6.1.5 battery gauge: It displays the battery storage. All bars lit: power is sufficient; 3-4 bars displayed indicates the power is ok. Lower than 2 bars indicates lack of power and the battery needs to be charged.

6.1.6 Joystick: The joystick is mainly used to control the wheelchair's movement including its speed and direction (forward, backward and left or right etc). The further you push the joystick from its central position, the faster the wheelchair moves. Whenever you release the joystick, it will automatically go back to the center and the brake will be automatically operative to stop the wheelchair.

6.1.7 Reserving sound can be closed by pressing the buttons of speed-down and horn simultaneously for 3 seconds. If need to turn it on, please press the buttons of speed-up and horn for 3 seconds at the same time, and then the sound will be on.

6.1.8 Charger Socket: It is only used to this wheelchair. Do not use the socket to supply power to any other electrical equipment. Otherwise, it may damage the wheelchair's control system or its E.M.C performance (Electromagnetic tolerance)(fig8).

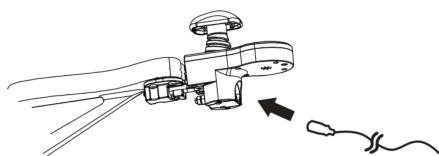

fig.8

6.2 Batteries and Its Usage

6.2.1 Fully charge your new battery prior to its initial use. This brings the battery up to about 90% of its peak performance level; Give the battery another full charge of 4-6 hours and operate your wheelchair again, the batteries will now perform at over 90% of their potential; After four or five charging cycles, the batteries will top off at 100% charge and last for an extended period. Please replace a new battery when the battery failure, and the old battery must be returned to supplier because of environmental pollution.

CAUTION!
Do not use your wheelchair when the temperature is less than -25 °C or above 50 °C.

Battery specification	
Type	Lithium battery
Dimension	162mm*145mm*44 mm
Power	24V

6.2.2 Charging batteries

The battery charger is an important part of the wheelchair. The off-board charger attached to this product can charge its batteries quickly and easily to make your wheelchair the best.

6.2.3 Safety Belt

For your safety on the way, you have to fasten the safety belt whenever you seat on the wheelchair. Snap the belt buckle so to hear a click (fig9)

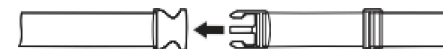

fig.9

WARNING!
Please charge the battery at environment temperature 0-35 °C. Otherwise, it will cause personal injury and battery damage.

6.3.1 Battery disassembly

Pull the lock and pull ring of the battery box outward to realize the disassembly and assembly of the battery box.(fig10)

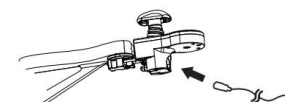

fig.10

6.3.2 Charge the battery with a battery charger

Verify that the controller is closed; confirm that the wheelchair is not in manual mode: connect the three-pin metal plug of the charger to the controller interface: insert the plug on the other end of the charger into the standard socket; then the blue light on the charger is on, and the green light is on after sufficient point: We recommend charging the battery for 4-6 hours.(fig11)

Method 1



Method 2

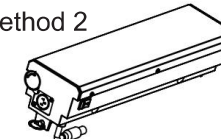

fig.11

6.2 Operation

6.2.1 Preparation before operation

- Do not turn on the power switch when sit on the power wheelchair, and do turn off the power switch when get off from the wheelchair. Please observe whether the hand brake works or not.
- Please fold the pedal first then hold the armrest to sit on the wheelchair; Do not get off the wheelchair by stepping on the pedal. Otherwise the chair maybe turned over, which is dangerous.

6.2.2 Practice before operation

- Find a spacious place like square and have a assistant to help you practice until you have enough confidence to operate it.
- Be certain to shut down the power when you up and down the wheelchair, and set a speed you need through speed adjustment button.
- We recommend you set the lowest speed until you can operate the electric wheelchair skillfully.
- To Practice the stop operation, forward and backward. Push the handle, the wheelchair move to anywhere you want.
- Firstly, ensure that it is the lowest speed when practice forward operation. After Skilled, you can practice "S" shaped turn. After you are familiar with "S" shaped turn, to practice backward operation, and pay attention to the speed control setting. And the backward speed should lower than forward speed.

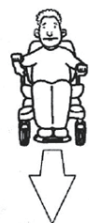
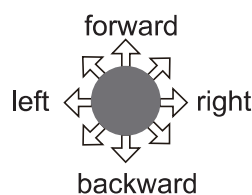

6.2.3 Operation

Please do it according to precautions operation.



WARNING!

Do not use your wheelchair unless getting help from your assistant when the wheelchair is in manual mode. Otherwise it may result in personal injury.

Do not set your wheelchair in manual mode by yourself while you are seated in the wheelchair. Otherwise it may result in personal injury. In this case, please ask your assistant to help you.

Do not set your wheelchair in manual mode when it is on an incline. Otherwise, the wheelchair could be out of control to roll down by itself, and result in personal injury.

7. Fault diagnosis and troubleshooting

This product has an automatic fault warning function to give you very convenience. Once it malfunctions, the LEDs on the controller will flash with alarm sounded by the horn. You can find where a fault is according to information in Table 2.

If the fault still exists after checking out the fault based on that in table 2, Please consult your service agent immediately.

Beep 2+1	Communication failure	Check connection inside the joystick
Beep 2+2	Right motor failure	Check right motor or wire connection
Beep 2+3	Right brake error or cable connection poor	Check if the brake lever is in place & if the brake is damaged
Beep 2+4	Left motor failure	Check left motor or wire connection
Beep 2+5	Left brake error or cable connection poor	Check if the brake lever is in place & if the brake is damaged
Beep 2+6	Overcurrent	Check if the motor is locked or short circuit or if the joystick is damaged
Beep 2+7	Joystick lever failure	Check if the joystick lever works normally or the inside connection is loose
Beep 2+8	Joystick failure	Check with supplier for repair
Beep 2+9	Battery failure	Charge the battery, if still not work, replace a new battery with same specification

8.Safety devices and accident treatment

8.1 Overload Protector: Refer to instruction manual 6.1.4

8.2 Safety belt: Refer to instruction manual 6.1.6

8.3 Please release the joystick whenever there is a wheelchair fault , the wheelchair will be stopped.

9.1Maintenance

Like other motorized vehicle, your power wheelchair also requires routine maintenance. Some checks can be performed by yourself, others you can ask for assistance from your service agent. Preventive maintenance is very important. If you follow the maintenance and checks in this section, your wheelchair will give you years of trouble-free operation. If you have any doubt your wheelchair's care or operation, please contact your service agent or our after-sale service dept.

9.1.1Humidity

Your wheelchair, like most electrical and mechanical equipment, is susceptible to external conditions. In any case, the wheelchair should be avoided damp environment. Direct or prolonged exposure to water or dampness could cause the wheelchair to malfunction electronically and mechanically. Water can cause electrical components and the chair's frame to corrode.

9.1.2Temperature

- Some parts of your wheelchair are susceptible to temperature.
- In extremely cold temperature, the battery may be frozen. Special temperatures may cause a lot of factors to freeze, like charger type, usage, battery components (such as sealed lead-acid batteries or gel batteries);
- Temperature above 55°may cause your wheelchair's speed to reduce.

9.1.3General Guidelines

- Avoid beating the controller, especially the joystick.
- Avoid prolonged exposure of your wheelchair to extreme conditions, such as hot, cold or moisture environment.
- Keep the controller clean.
- Check all electric connections, including the cable and connectors of the charger, and ensure that they are all tight and secure.
- If only red LEDs on the Battery Gauge lights, the batteries are nearly running out of charge. You should recharge the batteries as soon as possible. We recommend charging the battery for 8-12 hours
- Check the rear wheel inflatable situation, if the tire deformed serious when riding , it should be inflated;
- The frame surface has been sprayed with a clear sealant coating. You can apply a light coat of car wax to make the surface keep a high gloss.
- Check all cable connections. Make ensure they are fastened and are not corroded. The battery must be placed in the battery area, flat, the battery plug inward, relative display, refer to the correct connection on the main frame label;
- All wheel bearings are lubricated and sealed. Do not need to lubricate them.
- Check if there is loose phenomenon for wheel hub, drive device, and chair itself, if loose, please screw tightly in time.

9.1.4Maintenance after use

- Turn off the power.(please disconnect all the connectors if not use for long time.)
- Inhibit children and unconscious person to use the wheelchair.
- Store the wheelchair in normal temperature to prevent reformation so that it keeps its performances for long period.
- Clean the wheelchair with a clear and soft cloth and dry it. Never use any chemicals to clean it.(to prevent deformation and discoloration)
- Remove the cloth cover of the seat rest to be washed if it is dirty, and then dry it for use.

9.1.5 Daily Checks

In order to keep the wheelchair in good condition, you should check before each use. And to maintain the weekly, monthly, semi-annual investigation, check the project see (Table III).

Inspection Items	At any time	Weekly	Monthly	Six monthly
All parts			○	
Joystick function	○			
Brake System	○			
Connection		○		
Battery Condition	○			
Tire Condition			○	
Frame Condition				○
Front Wheel Condition		○		
Pureness	○			

9.1.6 Cleaning

Way of cleaning as below:

- Never wash your wheelchair with water or expose directly to water.
- Surface of wheelchair frame is coated with a protective coating. Therefore, it is very easy to wipe it clean with a damp cloth. Never use any chemicals to clean the vinylon seat and armrest, as they may cause the latter slip or chapped. You can use a damp cloth and neutral soapy water to clean them, and then dry thoroughly.

9.2 Repair

9.2.1 Users could repair or replace some spare parts like push handle, push handle cover which could be self-maintained or replaced by users under the instructions of after-sales service staff of our corporation or the dealers'.

9.2.2 Within the warranty, our corporation or the dealers will maintain or replace the faulted spare parts, like motor, battery, charger, controller, bearing, shaft sleeve, etc., due to material or manufacturing defects free of charge.

9.2.3 The spare parts like motor, controller, etc. which are confirmed by the after-sale staff or our corporation or our dealers' to be disassembled could be sent to our corporation or the dealers for maintenance.

9.2.4 Please contact your distributor or the after-sale service dept. of our corporation for any questions regarding the maintenance of power wheelchairs. Please refer to 12.1 Product Warranty.

10. Transportation and storage

10.1 Transportation

You can load and transport according to the shipping marks and graphics. For details, see the attachment.

10.2 Storage

Your wheelchair should be stored in a dry condition free from sources of extreme temperature and dampness. Remove the batteries from the wheelchair prior to storage. Otherwise, the frame may rust and the electronics may be damaged.

11. Opening and Checking

Open the packing box, and you can check whether there is anything missed or damaged.

Packing List

No.	Name	Quantity	Remark
1	Power Wheelchair	1pc	N5901
2	Charger	1pc	24V/2A
3	Instruction Manual	1pc	
4	footrest	2pc	
5	Controller	1set	

12. Quality Assurance

12.1 Warranty

12.2.1 Chair frame will have 5 years warranty service.

12.2.2 Within 1 year from the purchase date, for the following parts, we will supply free maintenance and replace service for original customer after the dealer check there are materials and production defect.







- Electrical control or lever system
- Motor/Drive System
- Bearing and shaft sleeve

12.2.3 Six-Months warranty for the batteries.

Please note the warranty service is provided by your dealer, and finally finished by our after-sales department and dealer together.

Out of warranty

- ABS plastic cover shell and rubber pad
- Tyre
- Interior decoration
- Damage by abuse, wrong operation, accidents and negligence
- Business use or other abnormal use

	Read and follow the information in the owner's manual.
	Locked and in drive mode. Place unit on level ground and stand to one side when changing from drive mode to freewheel mode or freewheel mode to drive mode. Unlocked and in freewheel mode.
	Class II Equipment
	Power Chair information label
	Manufactured in
	Do not remove the anti-tip wheels.

PRIDE[®]
MOBILITY PRODUCTS LTD.
LIVE YOUR BEST[®]

USA
Pride Mobility Products corp.
182 Susquehanna Avenue
Exeter, PA 18643-2694

Canada
Pride Mobility Products corp.
5096 South Service Road
Beamsville, Ontario L0R 1B3

Australia
Pride Mobility Products Australia Pty. Ltd.
20-24 Apollo Drive
Hallam, Victoria 3803
www.pridemobility.com.au

New Zealand
Pride Mobility Products New Zealand Ltd.
38 Lansford Crescent
Avondale
Auckland, New Zealand 1007
www.pridemobility.co.nz

UK
Pride Mobility Products Ltd.
32 Wedgwood Road
Bicester, Oxfordshire OX26
4UL www.pride-mobility.co.uk

Germany
Pride Mobility Products GmbH
Pride Mobility Products
GmbH Josef-Förster-Straße
6-833161 Hövelhof
Germany

UK Representative
SUNGO Certification
Company Limited
3rd floor, 70 Gracechurch
Street, London. EC3V 0HR

The Netherlands
Pride Mobility Products Europe BV
De Zwaan 3
1601 MS Enkhuizen
Netherlands
www.pride-mobility.nl

Italy
Pride Mobility Products Italia srl
Via del Progresso, ang. Via deL
Lavoro Loc. Prato della Corte
00065 Flano Romano (RM)
www.pride-italia.it

France
Pride Mobility Products SARL
26 rue Monseigneur Ancel
69 800 Saint-Priest
www.pridemobility.fr

Spain
Pride Mobility Products Spain SLU
Calle Velazquez 80 6D
28001 Madrid
www.pridemobility.com

EU Representative
Sung Europe BV
Fascinatio Boulevard 522,
Unit 1.7.2909VA
capelle aan den IJssel,
The Netherlands

Serial number: